



**SGH**  
concepts

## Architectural Product Information / Omaha Territories

For more than 75 years, SGH Concepts has been providing quality products and service. Our customers know that our products are second to none and are up-to-date with the latest designs and installation techniques. We thrive on finding solutions—collaborating with architects, designers, and contractors—throughout the entire design and construction process. Our goal is simple; to create buildings of lasting, enduring beauty.

[sghconcepts.com](http://sghconcepts.com)  
P 402.493.9393  
F 402.493.5934

TF 844.255.9393  
Omaha Office  
1111 Papillion Pkwy / Omaha, NE 68154

SGH Concepts, A Division of SGH Redglaze Holdings, Inc.





University of Nebraska-Omaha Mammel Hall / Omaha, NE  
Centria



St. John Paul II Newman Center / Omaha, NE  
Dri-Design & Phenolic Panels



Montana Tech NRRC / Helena, MT  
Swisspearl & Centria



Krone Advising Center Morningside College / Sioux City, IA  
Zinc Flatlock



SCC Health & Sciences Building | Lincoln, NE  
Genwall & Swisspearl



University of Nebraska-Lincoln Student Union / Lincoln, NE  
Skyfold



City Brew Coffee / Great Falls, MT  
A-Plank



Veridian Credit Union / Omaha, NE  
A-Plank & Sieccoline

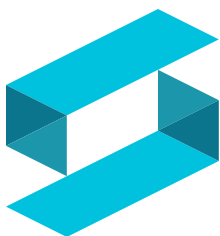

**SGH**  
concepts

[sghconcepts.com](http://sghconcepts.com)

Providing smarter solutions from  
concept to design while  
collaborating with you to give  
form to your vision.

## Products / Descriptions



Palisades Ranch / Red Lodge, MT  
Kalwall



Drop Zone Family Fun Center / Sioux City, IA  
Kalwall

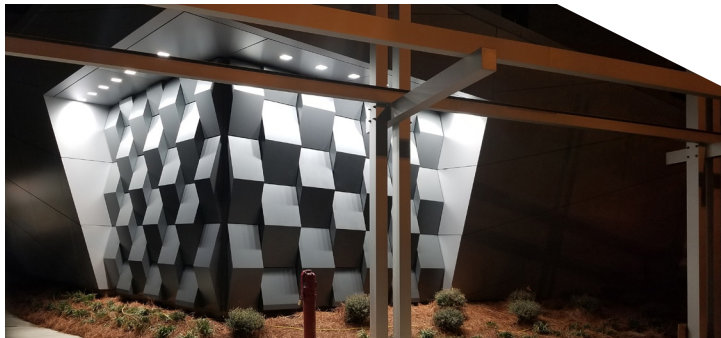

Brookwood Hospital / Birmingham, AL  
Sieccoline



SCC Health & Sciences Building / Lincoln, NE  
Genwall Insulated Backup Wall System

EXTERIOR PANEL SYSTEMS	A-Plank	Solid extruded aluminum plank siding.
	Centria	Metal wall panel & roof systems.
	Dizal®	UV-stable, digitally-printed, aluminum rainscreen.
	Dri-Design®	Dry-joint rainscreen; aluminum, SS copper panels.
	NedZink®	Innovative solutions in zinc for building envelopes.
	Swisspearl®	Fiber-cement, rear-ventilated façade panels, rot-resistant, noncombustible
	Trespa®	High-pressure laminated phenolic panels provide extremely weather protection and are graffiti-resistant.
ACM/MCM <sup>1</sup> PANELS	Revelar*	Open-joint, rear-ventilated ACM rainscreen with exposed fasteners.
	Sieccoline*	Dry-joint, rear-ventilated ACM rainscreen.
BACKUP SYSTEMS	Genwall®	Innovative stud-to-skin insulated composite backup panel system that exceeds newest IBC & NFPA codes.
	StronGirt™	Insulation composite girt system.
DAYLIGHTING SYSTEMS	Kalwall®	High-performance translucent daylight systems for walls and roofs.
	Structures Unlimited®	Translucent skylight and support systems.
	Skyline Sky-Lites	Skylight systems from small domes to spanning structures.
	Solatube®	Tubular daylighting system.
SERVICES	Daylighting Maintenance & Retrofit	Inspections, reporting, weather impact report, maintenance, repair, & replacement.
	Fabrication Services	Specialized brand elements & building envelope fabrication.
INTERIOR PRODUCTS	Modernfold™	Operable walls and accordion partitions.
	Skyfold®	Custom vertical folding, powerlift partitions.
	Smoke Guard®	Smoke and fire rated curtains.
OTHER	Sentech Architectural Systems	Structural glass systems.
	Custom Products	Engineered and fabricated ornamental metals and cladding.

- Design Assistance
- Detailing Assistance
- Preliminary Budgets
- Project Estimates
- Project Management
- Engineering & Shop Drawings
- Daylighting / Skylights Services
- Installation
- Service/Maintenance

\*Reynobond, Alucobond, or Alpollic stock  
MCM is available for ACM/MCM<sup>1</sup> panel



Waukee Elementary School #8 / Waukee, IA  
Solatube



Elkhorn South High School / Elkhorn, NE  
Centria & Kalwall



Montana State Fund Bank / Helena, MT  
Swisspearl, Kalwall, & Misc.



Delta Hotels by Marriott South Sioux City Riverfront / Sioux City, NE  
Genwall, Dri-Design & Sieccoline



Girls, Inc. / Omaha, NE  
Genwall, Sieccoline, Zinc & Misc.



CLAAS of America Training Academy / Omaha, NE  
Skyfold

**SGH Concepts** is centrally located in seven cities serving ten states.

**Omaha (Headquarters)**  
1111 Papillion Pkwy  
Omaha, NE 68154

**Des Moines**  
3100 101st Street, Ste. A  
Urbandale, IA 50322

**Kansas City**  
1800 N.W. Vivion Road  
Kansas City, MO 64150

**Wichita**  
327 N Hydraulic Ave #200  
Wichita, KS 67214

**Billings**  
1113 Central Avenue  
Billings, MT 59102

**Denver**  
15603 E. Fremont Drive, Ste. A  
Centennial, CO 80112

**Minneapolis**  
Bloomington, MN 55425

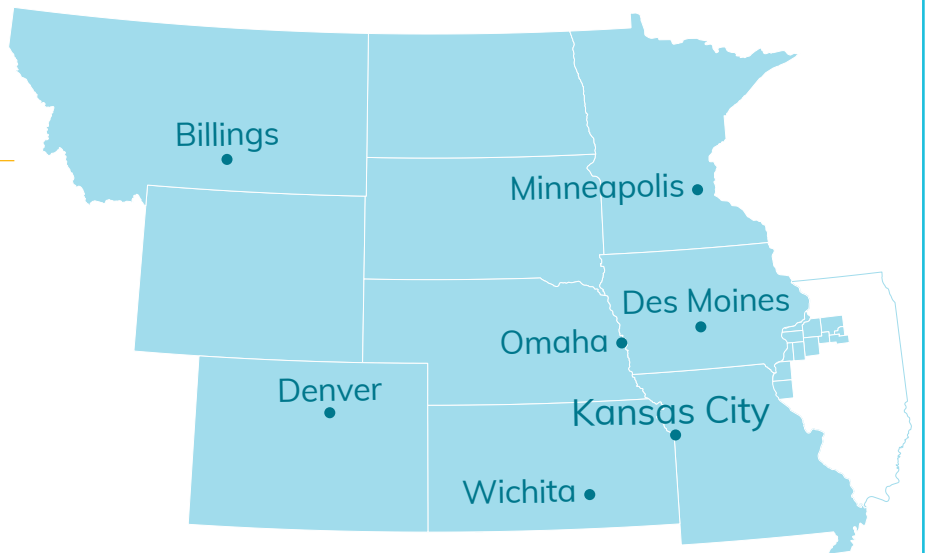

Front TB: Kalwall & Centria on Waukee High School / Solatube in Kum & Go / Centria on UNL Bob Devany Sports Center / Skyfold in Elkhorn Public Schools  
Phenolic Panels on Iowa Western Community College Arts Building / Centria & Dri-Design on Elkhorn North High School