



SGH
concepts

Architectural Product Information / Omaha Territories

For more than 70 years, SGH Concepts has been providing quality products and service. Our customers know that our products are second to none and are up-to-date with the latest designs and installation techniques. We thrive on finding solutions—collaborating with architects, designers, and contractors—throughout the entire design and construction process. Our goal is simple; to create buildings of lasting, enduring beauty.

sghconcepts.com
P 402.493.9393
F 402.493.5934

TF 844.255.9393
Omaha Office
742 N. 109th Ct. / Omaha, NE 68154

SGH Concepts, A Division of SGH Redglaze Holdings, Inc.





University of Nebraska-Omaha Mammel Hall / Omaha, NE
Centria



St. John Paul II Newman Center / Omaha, NE
Dri-Design / Fundermax



Montana Tech NRRC / Helena, MT
Swisspearl / Centria



Krone Advising Center Morningside College / Sioux City, IA
Zinc Flatlock



SCC Health & Sciences Building | Lincoln, NE
Swisspearl / Genwall



University of Nebraska-Lincoln Student Union / Lincoln, NE
Skyfold



City Brew Coffee / Great Falls, MT
A-Plank



Veridian Credit Union / Omaha, NE
A-Plank



SGH
concepts

sghconcepts.com

Providing smarter solutions from
concept to design while
collaborating with you to give
form to your vision.



Palisades Ranch / Red Lodge, MT
Kalwall



Drop Zone Family Fun Center / Sioux City, IA
Kalwall

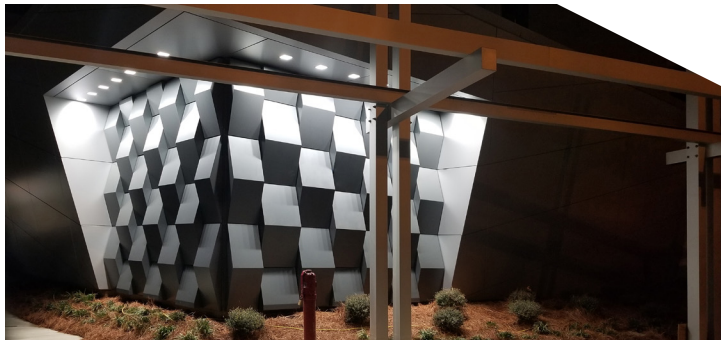

Brookwood Hospital / Birmingham, AL
Sieccoline



SCC Health & Sciences Building / Lincoln, NE
Genwall Insulated Backup Wall System

Products / Descriptions

EXTERIOR PANEL SYSTEMS	A-Plank	Solid extruded aluminum plank siding.
	Centria	Metal wall panel & roof systems.
	Dizal®	UV-stable, digitally-printed, aluminum rainscreen.
	Dri-Design®	Dry-joint rainscreen; aluminum, SS copper panels.
	Fundermax®	High-pressure laminated phenolic panels provide extremely weather protection and are graffiti-resistant.
	Swisspearl	Fiber-cement, rear-ventilated façade panels, rot-resistant, noncombustible.
	NedZink®	Innovative solutions in zinc for building envelopes.
ACM/MCM¹ PANELS	Revelar*	Open-joint, rear-ventilated ACM rainscreen with exposed fasteners.
	Sieccoline*	Dry-joint, rear-ventilated ACM rainscreen.
BACKUP SYSTEMS	Genwall®	Innovative stud-to-skin insulated composite backup panel system that exceeds newest IBC & NFPA codes.
	StronGirt™	Insulation composite girt system.
DAYLIGHTING SYSTEMS	Kalwall®	High-performance translucent daylight systems for walls and roofs.
	Structures Unlimited®	Translucent skyroof and support systems.
	Skyline Sky-Lites	Skylight systems from small domes to spanning structures.
	Solatube®	Tubular daylighting system.
SERVICES	Daylighting Maintenance & Retrofit	Inspections, reporting, weather impact report, maintenance, repair, & replacement.
	Fabrication Services	Specialized brand elements & building envelope fabrication.
INTERIOR PRODUCTS	Modernfold™	Operable walls and accordion partitions.
	Skyfold	Custom vertical folding, powerlift partitions.
	Smoke Guard®	Smoke and fire rated curtains.
OTHER	Sentech Architectural Systems	Structural glass systems.
	Custom Products	Engineered and fabricated ornamental metals and cladding.

- Design Assistance
- Detailing Assistance
- Preliminary Budgets
- Project Estimates
- Project Management
- Engineering & Shop Drawings
- Daylighting / Skylights Services
- Installation
- Service/Maintenance

*Reynobond, Alucobond, or Alpollic stock
MCM is available for ACM/MCM¹ panel



Waukee Elementary School #8 / Waukee, IA
Solatube



Elkhorn South High School / Elkhorn, NE
Centria / Kalwall



Montana State Fund Bank / Helena, MT
Swisspearl / Kalwall / Misc.



Delta Hotels by Marriott South Sioux City Riverfront / Sioux City, NE
Dri-Design / Genwall / Sieccoline



Girls, Inc. / Omaha, NE
Genwall / Sieccoline / Misc. / Zinc



CLAAS of America Training Academy / Omaha, NE
Skyfold

SGH Concepts is centrally located in seven cities serving ten states.

Omaha (Headquarters)
742 N. 109th Court
Omaha, NE 68154

Des Moines
3100 101st Street, Ste. A
Urbandale, IA 50322

Kansas City
1800 N.W. Vivion Road
Kansas City, MO 64150

Wichita
8201 E. 34th St. Cir N, Ste 903
Wichita, KS 67226

Billings
1113 Central Avenue
Billings, MT 59102

Denver
15603 E. Fremont Drive, Ste. A
Centennial, CO 80112

Minneapolis
Bloomington, MN 55425

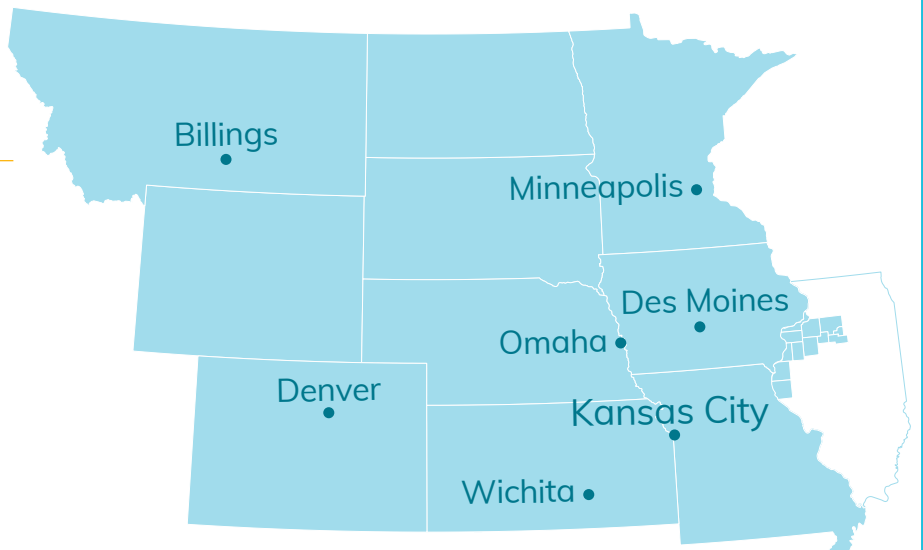

Front TB: Kalwall & Centria on Waukee High School / Solatube in Kum & Go / Centria on UNL Bob Devany Sports Center / Skyfold in Elkhorn Public Schools
Dri-Design on Iowa Western Community College Arts Building / Centria & Dri-Design on Elkhorn North High School